



KALIACHAK BIKRAM KISHORE ADARSH SANSKRIT MAHAVIDYALAYA

Recognised by : Central Sanskrit University, New Delhi.
Under Ministry of Education.

Government of India

Vill. - Kaliachak * P.O. - Heria * Dist. - Purba Medinipur * West Bengal * Pin- 721430
Tele Phone : 7718624994 Email - kaliachakbkasm@yahoo.com / @gmail.com

Dated-20-03-2025

Spot Bid Quotation Notice

Sealed quotations are invited on behalf of the Principal, Kaliachak Bikram Kishore Adarsh Sanskrit Mahavidyalaya. Ref:- Kaliachak B.K/Construction/Guard-Wall/2025-2026/01, dated – 20/03/2025, from Government approved firms/contractors for Construction of Guard-wall with Boundary wall. Specifications of the said work can be obtained from Mahavidyalaya's website - <http://kaliachakbkasanskritmahavidyalaya.org>

Cost should include GST or any other taxes.

- Last date for submission of Quotation :

27/03/2025

(From 11:00 A.M to 03:00 P.M in
the Mahavidyalaya office)

- Quotation opening date :

28/03/2025

At 02:00 P.M

Dr. Debipada Rath
20/3/2025

Principal

Dr. Debipada Rath
PRINCIPAL

Kaliachak Bikram kishore Adarsh
Sanskrit Mahavidyalaya
P.O.- Heria, Purba Medinipur, W.B., Pin- 721430

ESTIMATE

Estimated Cost for Construction of R.C.C. Raft with Grid Beam between columns of West Block and Retaining wall with Boundary Wall of Kaliachak Bikram Kishore Adarsh Sanskrit Mahavidyalaya, Kalyachak, P.O. Heria, (Pin-721430) Dist.- Purba Medinipur, West Bengal.

Length of Building effected- 40.99 mtr.

Length of Guard wall with Boundary wall- 73.40 mtr.

(Rate as per P.W.D. Schedule)

<u>Sl. No</u>	<u>Description of items</u>	<u>Quantity</u>	<u>Unit/Rate</u>	<u>Amount</u>
1.	<u>P-1/lt -2 of PWD(B) Sch.</u> Earth work in excavation of foundation trenches or drains, in all sorts of soil (including mixed soil but excluding laterite or sand stone) including removing, spreading or stacking the spoils within a lead of 75 metre as directed. The item includes necessary trimming the sides of trenches, leveling, dressing and ramming the bottom, bailing out water as required complete. a) Depth of excavation not exceeding 1.5 metre (not required shoring)			
		139.44 m3	119.27/m3	16,631.00
2.	<u>P-2/lt 4(A) of PWD(B) Sch.</u> Filling in foundation or plinth by silver sand in layers not exceeding 15 cm. As directed and consolidating same by thorough saturation with water, ramming complete including the cost of supply of sand. Payment to be made on measurement of finished quantity.			
		65.86 m3	543.51	35,796.00
3.	<u>P-14/lt-1 of PWD(B) Sch. 3rd Corrigenda & Addenda of SOR of PWD(WB)w.e.f 01.11.2017 DOP -04/06/2018.</u> Single brick flat soling or picked jhama brick including ramming and dressing bed to proper level and filling joints with local sand.			
		91.07 m2	348.00/m2	31,692.00
4.	<u>P-23/lt -1 of PWD(B) Sch.- 3rd Corrigenda & Addenda of SOR of PWD(WB)w.e.f 01.11.2017 DOP -04/06/2018.</u> Cement concrete with graded jhama khoa (30mm. size) excluding shuttering and ground floor and foundation. (a) 1:3:6 Proportion.			
		11.93 m3	4,439.00/m3	52,957.00
5.	<u>P-15/lt -8 of PW(B) Sch. 3rd Corrigenda & Addenda of SOR of PWD(WB)w.e.f 01.11.2017 DOP -04/06/2018.</u> Brick work with 1 st Class Brick in cement mortar (6:1) (a) in foundation and plinth.			
		114.93 m3	5198.00/m3	5,97,406.00

	<u>P-15/lt -8 of PW(B) Sch. 3rd Corrigenda & Addenda of SOR of PWD(WB)w.e.f 01.11.2017 DOP -04/06/2018.</u> Brick work with 1 st Class Brick in cement mortar (6:1) (b) In Superstructure.			
		4.91 m2	5198.00/m2	25,522.00
7.	<u>P-16/it-16 of PWD(B) Sch. 3rd Corrigenda & Addenda of SOR of PWD(WB)w.e.f 01.11.2017 DOP -04/06/2018.</u> 125cm.thick brick work with 1 st Class brick work in cement mortar (1:4) in Ground floor.			
		114.85 m2	712.00/m2	81,773.00
8.	<u>P-26/lt -10 of PWD(B) Sch. - 3rd Corrigenda & Addenda of SOR of PWD(WB)w.e.f 01.11.2017 DOP -04/06/2018(Rate Analysis).</u> Ordinary Cement concrete (mix 1:1.5:3)with graded stone chips (20mm. nominal size) excluding shuttering & reinforcement if any, In Ground floor as per relevant I.S. Codes. (i) Pakur variety			
		28.64 m3	6,509.62/m3	1,86,436.00
9.	<u>P-43/lt -40 of PWD(B)Sch. - 10th Corrigenda & Addenda dt. 22.01.2020 for SOR PWD (WB) w.e.f. 01.11.2019.</u> Reinforcement for reinforced concrete work in all sorts of structures including distribution bars, stirrups, binders etc. initial straightening and removal of loose rust (if necessary), cutting to requisite length, hooking and bending to correct shape, placing in proper position and binding with 16 gauge black annealed wire at every inter section, complete as per drawing and direction. (a) For works in foundation upto roof of ground floor upto 4mtr. I. SAIL/TATA/RINL @1.30% of Concrete volume			
		2.810 MT	60,433.00/MT	1,69,817.00
10.	<u>P-42/lt -36 of PWD(B)Sch</u> Hire and labour charges for shuttering with centering and necessary staging upto 4MT using approved stout props & thick hard wood planks of approved thickness with required bracing for concrete slab, beams & Columns, lintel curved or straight including fitting fixing and striking out after completion of works (upto roof of ground floor). a) 25mm. to 30mm. thick wooden shuttering as per decision and direction of E.I.C.			
		68.96 M2	324.00/m2	22,343.00
11. (a)	<u>P-189/lt-1(i)(c) of PWD(B) Sch. 3rd Corrigenda & Addenda of SOR of PWD(WB)w.e.f 01.11.2017 DOP -04/06/2018.</u> Plaster (to wall, floor, ceiling etc.) with sand and cement mortar including rounding off or chamfering corners as directed and raking out joints including throating nosing and drip course, scaffolding staging where necessary. (i) With 1:6 cement mortar c) 20mm. thick Plaster			
		388.10 m2	159.00/m2	61,708.00

	P-192/it-15 of PWD(B) Sch. Neat cement punning about 1.5 mm. thick in wall dado, window, sills, floor, drain etc. Note : Cement 0.152 cum per 100 sq.m.			
		89.53 m2	34.00/m2	3,044.00
13.	P-196/It-8 of PWD(B) Sch. Applying Exterior Grade Acrylic Primer of approved quality & brand on plastered or concrete surface old or new surface to received decorative texture (Matt finish) or smooth finish Acrylic exterior Emulsion paint including scrapping & preparing surface thoroughly, complete as per manufacturer's specification and direction of E.I.C. In ground Floor (a) one coat			
		298.57 m2	31.40/m2	9,375.00
14.	P-197/It-17a of PWD(B) Sch. Protective & Decorative Acrylic exterior emulsion paint of approved quality, as per manufacturer specification and as per direction of E.I.C. to be applied over Acrylic primer as required. The rate includes cost of materials labour Scaffolding & all incidental charges but excluding the cost of primer. In ground floor (two coats) (a) Normal Acrylic Emulsion.			
		298.57 m2	67.00/m2	20,004.00
				13,14,504.00
	(+) Add 18% GST			2,36,611.00
				15,51,115.00
	(+) 1% CESS			15,511.00
			Total : Rs.	15,66,626.00

Total Rupees Fifteen lakh sixty six thousand six hundred twenty six only.

Estimated by-

Sayan Gopi Giri
21/2/2025
Sayan Gopi Giri
B.Tech. (Civil)
Reg. No. 101/11/2017-022, dated 2018
Faculty of Engineering, CUBA Medinipur

PLAN FOR PROPOSED LOAD BEARING WALL (R.C.C. RAFT WITH GRID BEAM) BETWEEN COLUMNS OF WEST BLOCK AND RETAINING WALL WITH BOUNDARY WALL OF "KALIACHAK BIKRAM KISHORE ADARSH SANSKRIT MAHAVIDYALAYA" AT KALIACHAK,P.O. - HERIA (PIN - 721430),DIST - PURBA MEDINIPUR.

LENGTH OF BUILDING EFFECTED - 40.99 Mtr.

LENGTH OF RETAINING WALL WITH BOUNDARY WALL - 74.40 Mtr.

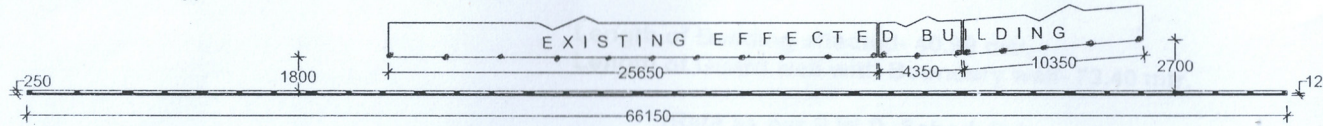

PROPOSED BOUNDARY WALL PLAN

SCALE - 1 : 250

TIE BEAM AND COLUMN OF EXISTING EFFECTED BUILDING

TIE BEAM AND COLUMN OF EXISTING EFFECTED BUILDING

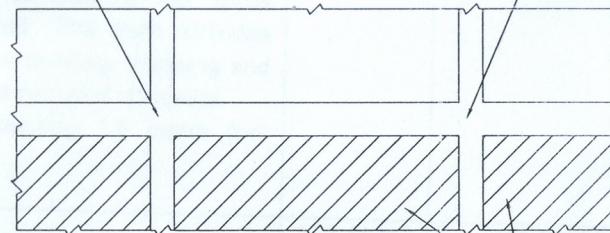

TYPICAL LONGITUDINAL PLAN OF LOAD BEARING WALL

SCALE - 1 : 50

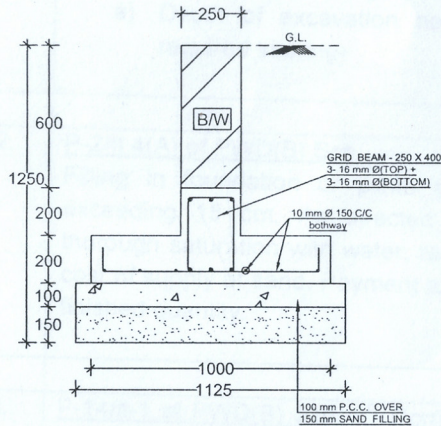

DETAILS OF R.C.C. RAFT WITH GRID BEAM & BRICK WALL (LOAD BEARING WALL)

SCALE - 1 : 20

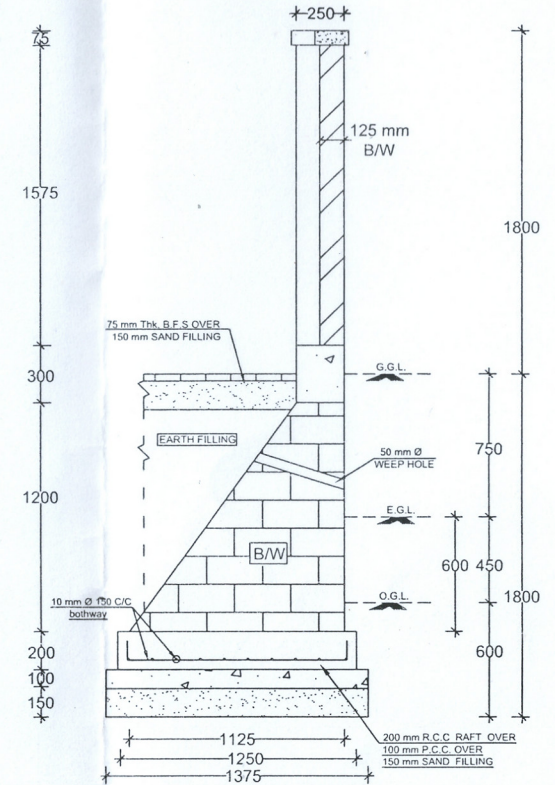

DETAILS OF RETAINING WALL WITH BOUNDARY WALL

SCALE - 1 : 25

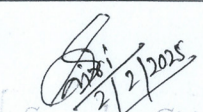
		 2/2/2025 Sayandeep Giri B.Tech. (Civil) Reg.No - 10127010429/13-14 Member of P.E.
SIGNATURE OF AUTHORITY	SIGNATURE OF ENGINEER	